

INSTANT BOOK

ORGATEC 2016





MDF ITALIA

*Milano Design Furniture.
New Headquarter*

Synthesis of lightness, simplicity, innovation, emotion and meaning. MDF Italia designs furniture that integrates creativity, innovation and technology, and aims at creating emotional products, that are silently surprising.

LIGHTNESS

IDENTITY





Simplicity is a philosophy that can be applied to almost everything in life. First and foremost it is a cultural approach, a way of perceiving change, the belief that complex problems can also have simple solutions. This is the perfect summary of MDF Italia's philosophy.

SIMPLICITY

Over the years, the power of ideas and the stimulus of innovative design have succeeded in breaking the rigid definition of types and overcoming the limitations imposed by materials. Regardless of the material used, materials are neither thought to be external nor limiting elements of a project, but rather part and parcel of the project.

INNOVATION



Smart working, wellbeing, creativity. Contemporary workspaces, where to enhance resources and favour exchange of ideas, together with moments of individual concentration. Cross collections. Essential and flexible design for any type of layout and end-use.

CONTRACT



COLLECTION

selection

Globalisation and cultural contaminations have changed spaces and lifestyles and are still changing them. MDF Italia faces the challenge of meeting the desires of increasingly demanding, curious and cosmopolitan consumers.

MDF Italia provides solutions combining emotion and functionality, through research and strong innovation. Process, ideas, shapes, signs, materials, design innovation. This is MDF Italia's hallmark, together with thought and designing quality.



In the next pages you can find a set of products that are suitable for several uses in domestic and working spaces and for the community.
To surf the entire collection MDF Italia, download the new Collection Book.

FLOW COLLECTION

designed by Jean Marie Massaud



The versatile family of the Flow seatings, is usable for the home, the office and the community areas. The bases are supplied in the same colour of the shell, available in the following options: 4-legged base, sled base, VN 4-legged steel base, LEM 4-legged base, fixed 5 point-star base, height-adjustable 5-point-star base on castors, with central leg, VN 4-legged oak base and 4-legged oak base. Flow Chair and Flow Slim seatings can be completed with upholstery, fabric or leather. Optionals: upholstered PAD available for Flow Chair, Flow Slim and Flow Stool.

Outdoor use: availability of outdoor versions with a 4-legged or a sled base in white, or graphite grey. Flame retardant padding: norms 1IM, California TB 117-2013 and BS are available upon request.



INDOOR/OUTDOOR



CHAIR
4-LEGGED BASE
L53 D54 H80.5 SEAT H44



SLIM PADDED
SLED BASE
L55 D53.1 H76.4 SEAT H44



SLIM
LEM 4-LEGGED BASE
L65 D65 H76.4 SEAT H44



SLIM
5-POINT STAR BASE
L67 D67 H76.4 SEAT H41.2/51.2



SLIM
BASE WITH CENTRAL LEG
L55 D54 H76.4 SEAT H44



SLIM
VN 4-LEGGED STEEL BASE
L56 D56 H76.4 SEAT H44



CHAIR
VN 4-LEGGED STEEL BASE
L56 D56 H80.5 SEAT H44



CHAIR PADDED
VN 4-LEGGED OAK BASE
L56 D56 H80.5 SEAT H44



CHAIR
4-LEGGED OAK BASE
L54 D54 H80.5 SEAT H44



SLIM PADDED
4-LEGGED OAK BASE
L55 D54 H76.4 SEAT H44



POUF
4-LEGGED OAK BASE
L54 D54 SEAT H48



STOOL
VN 4-LEGGED STEEL BASE
L54 D54 SEAT H78

AÏKU

designed by Jean Marie Massaud



AïKU is the new collection of chairs, designed for both home and contract spaces, available in six versions of bases and a wide range of finishes. Shell made from two-colour polypropylene, gloss outside, with matt saffiano effect in different colours inside. Bases: 4-legged round-shaped base, sled base, sled base with armrests and table, 4-legged tapered base and 4-legged base in solid oak. Versions with 4-legged round-shaped base, sled bases and 4-legged tapered base are stackable. Accessories: coupling device to align chairs, trolley for stacking, seat numbering and upholstered PAD.

0014
0015

INSTANT BOOK



4-LEGGED
TAPERED BASE
L58 D55 H78 SEAT H46.1



SLED BASE
L59.2 D55 H78 SEAT H46.1



SLED BASE
WITH ARMRESTS
L59.2 D55 H78 SEAT H46.1



4-LEGGED
ROUND-SHAPED BASE
L57.6 D55 H78 SEAT H46.1



4-LEGGED
ROUND-SHAPED BASE
L57.6 D55 H78 SEAT H46.1



SLED BASE
WITH TABLE
L62 D55 H78 SEAT H46.1



4-LEGGED
TAPERED BASE
L58 D55 H78 SEAT H46.1



SLED BASE
WITH TABLE
L62 D55 H78 SEAT H46.1



4-LEGGED OAK BASE
L50 D55 H78 SEAT H46.1



4-LEGGED OAK BASE
L50 D55 H78 SEAT H46.1



4-LEGGED OAK BASE
L50 D55 H78 SEAT H46.1



4-LEGGED OAK BASE
L50 D55 H78 SEAT H46.1

ACHILLE

designed by Jean Marie Massaud



A padded chair and armchair of great impact and comfort. Frame in metal tubing, foamed with polyurethane rubbers, upholstered with fabric. The upholstery in fabric or in leather, is fully removable and covers the whole armchair. Only Achille chair is stackable.

Flame retardant padding: norms 11M, California TB 117-2013 and BS are available upon request.



ACHILLE CHAIR
L56 D52 H75 SEAT H47



ACHILLE ARMCHAIR
L58 D56 H75 SEAT H46

SAG

designed by Nendo



Either stool or low table, outdoor or indoor, Sag represents a polyhedral and functional complement. Designed as a whole piece folded on itself, as a fabric suspended in the air and melted in three directions into a single shape. Frame in stiff polyurethane called TECH, available in goffered matt white and matt mud. Seat available in polyurethane called Freeform and bamboo.

Outdoor use: only the variant with frame and seat in polyurethane is recommended also for outdoor use.

INDOOR/OUTDOOR

—
Ø40 H43/44



MIA

designed by Francesco Bettoni



A compact, soft, comfortable armchair with a strong personality has joined the MDF Italia collection. Mia collection is characterized by a soft compact armchair, sofas and pouf, with a strong character enhanced by its tone-on-tone or contrasting trim. The armchair is available with a fixed or with a 360° returning swivel base. The sofas, are integrating the collection offering three upholstered elements with smaller dimensions matching any ambient.

Flame retardant padding: norms 1IM, California TB 117-2013 and BS are available upon request.



ARMCHAIR
L87 D83 H70
SEAT H43 D55

POUF
L64 D45 H38
L70 D70 H38



2 SEATS - L
L150 D83 H70
SEAT H43 D55



2 SEATS EXTRA - XL
L174 D83 H70
SEAT H43 D55



2 SEATS - L
L150 D83 H70
SEAT H43 D55



3 SEATS - XXL
L214 D83 H70
SEAT H43 D55

YALE

designed by Jean Marie Massaud



An armchair and sofas of strong image featuring a wide shape cushioning, which provides a great comfort and functionality. Available the version with a deeper seat and version in down. Three pouf models always in the same finish as the sofa.

Frame in extruded aluminium, die-cast aluminium legs lacquered in matt black or white, or in gloss white. All cushions are structural and come with removable covers.

Flame retardant padding: norms 1IM, California TB 117-2013 and BS are available upon request.

Low coffee tables, in rectangular and square shape, featuring the same design of the Yale sofa frame.



—
AMCHAIR VERSION IN DOWN
L100 D86 H76
SEAT H42 D76



—
AMCHAIR VERSION IN WADDING
L100 D86 H76
SEAT H42 D76



—
COFFEE TABLE
H30 W44 L150 H19 W75 L75
H30 W75 L75, L150 H19 W140 L140
H30 W140 L140



—
SOFA VERSION IN WADDING
H76 D86 L160, L220, L260
SEAT H42 D76



—
SOFA VERSION IN WADDING | DEEP VERSION
H76 D104 L220, L250
SEAT H42 D94



—
SOFA VERSION IN DOWN
H76 D86 L160, L220, L260
SEAT H42 D76



—
SOFA VERSION IN DOWN | DEEP VERSION
H76 D104 L220, L250
SEAT H42 D94

BORA BORA

designed by Piergiorgio Cazzaniga, Andrei Munteanu



A modular seating system with highly functional configurations. The peculiar design in the backrest allows variability in depth. The frame of the sofa is in solid wood, suspension with elastic belts covered with variable density polyether. Cylindrical small feet in polished aluminium or in white or black lacquered steel, height 15 cm. The upholstery covers every part of the sofa and is completely removable.



L300 D90



L300 D390



L300 D390



L300 D390

TENSE & TENSE MATERIAL

designer Piergiorgio Cazzaniga, Michele Cazzaniga



Table featuring mono-material finishes. The important technological innovation it incorporates, combined with the tensioning capacity of the components makes it possible to build tabletops in large sizes which remain perfectly flat and also extremely light. A table available in two versions: mono-material finish in matt white, monochromatic finish in matt black and turtledove and Tense Material in natural oak wood, stone and brass. Availability of equipped tables, with one or two openings for cable management and 'undertop' cable tray.

TENSE
H73
W90 L160, 180, 200, 220, 240
W100 L200, 220, 240, 260, 280, 300
W120 L120, 240, 260, 280, 300, 360, 400
W150 L150, 200, 240, 300, 360, 400

TURTLEDOVE MAX H73
W120 L300

TENSE MATERIAL
H73
W90 L160, 180, 200, 220, 240
W100 L200, 220, 240, 260, 280, 300
W120 L120, 240, 260, 280, 300, 360, 400
W150 L150, 200, 240, 300, 360, 400

BRASS MAX H73
W90 L160, 180, 200, 220, 240
W98 L200, 220, 240, 260, 280, 300



WHITE



WOOD



TURTLEDOVE



BRASS



BLACK



STONE

ROCK TABLE

designed by Jean Marie Massaud



A mixture of natural and industrial materials, that are blended to create a new product with a smooth design. Rock Table is a collection of tables suited to both home and contract settings, with bases in UHPFRC cement in natural or anthracite. Tops in MD-wood fibreboard in white matt lacquer or white UHPFRC cement (with bases in natural cement); matt grey lacquer, anthracite UHPFRC cement or smoked tempered glass (with bases in anthracite grey cement). The bases are made of UHPFRC (ultra-high performance fibre-reinforced cement) with cutting-edge technical/structural properties.

The table with cement top is also suitable for outdoor.



INDOOR/OUTDOOR



NARROW BASE
Ø80 H110



NARROW BASE
Ø80, Ø100 H73



WIDE BASE
Ø120, Ø140 H73*



WIDE BASE
Ø120, Ø140 H73*

*TABLES WITH GLASS TOP H 71.5

DESK 3.0

designed by Bruno Fattorini, Francesco Bettoni

Family of workstations composed of aluminium frame and HPL tabletop, either in white, black or light grey. Monochrome tables are complete with inspectionable raceway for wiring and cable access spring. The following versions are available: single version (desktop) with cable management tabletop and double version (with front seats) with cable management tabletop. Frame and legs, 45x45 cm section, are in epoxy coated aluminium either in white, graphite grey or light grey colours. Concealed joint. Accessories available for workstations: cable management door, PC holder and chest of drawers.



—
SINGLE VERSION
H75
W80 L160, 180, 200, 220
W90 L160, 180, 200, 220
—
FRONT SEAT VERSION
H75
W180 L160, 180, 200, 220, 320



—
SINGLE VERSION
LIGHT GREY



—
SINGLE VERSION
BLACK



—
SINGLE VERSION
WHITE



—
DOUBLE VERSION
WHITE



—
DOUBLE VERSION
WHITE



—
DOUBLE VERSION
WHITE

RANDOM COLLECTION

designed by Neuland Industriedesign



Random, Random Box and Random Cabinet, freely combinable, stand for a flexible and original furnishing system of great impact, conceived to store and display objects in the available space. Suitable for the home office as well. The different units of the system can be freely combined resulting in a customized sculptural bookcase based on one's own visual taste and space requirements. The Random Cabinet unit can always be turned upside down. By flanking more units, this gives the composition a visual continuous or discontinuous pattern. Framework made of medium-density wood fibreboards, in micro goffered white lacquer. Uprights and shelves in thickness 6mm. The back is made from white melamine coated board (thickness 10 mm). BOX A, B and C only for Random.



RANDOMITO
L81.6 D20 H96



RANDOMISSIMO
L55 D23 H47.8
L34 D23 H47.8



RANDOM
L81.6 D25 H217



RANDOM BOX
L81.6 D35 H217



RANDOM CABINET
L81.6 D35 H217

MINIMA 3.0 & MINIMA 42

designed by Fattorini+Rizzini+Partners

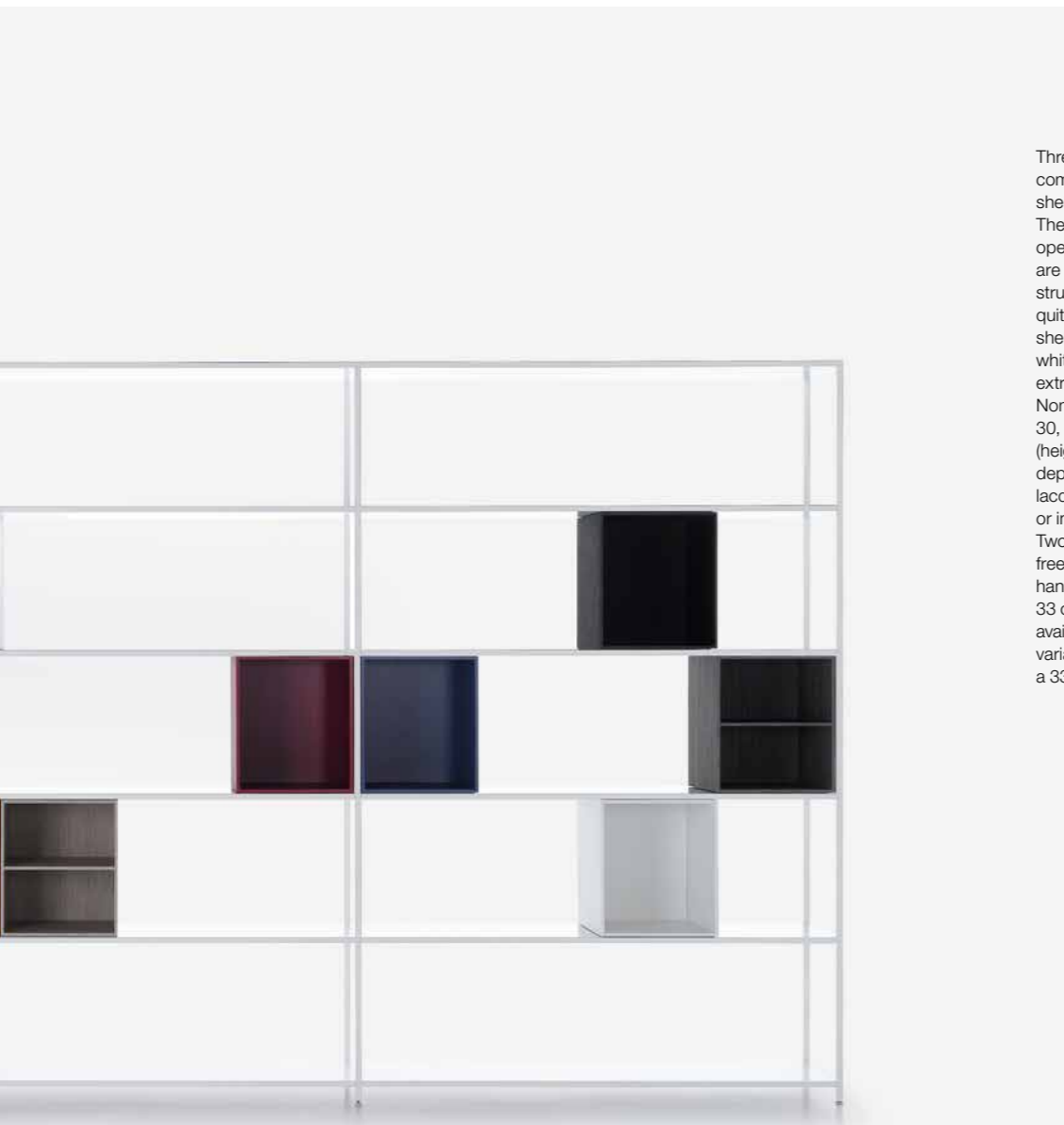

Three key elements that compose the system: shelf, frame, cabinets. The storage units (with door, flap opening door, drawers, or open) are simply resting inside the structure and are repositionable quite easily. Uprights and shelves made of matt lacquered white and graphite grey extruded aluminium.

Nominal lengths of cabinets: 30, 60, 90 cm, height 35 cm (height 42 for Minima 42) and depth 33 cm. Available in a matt lacquered micro-goffered finish or in a wood variant.

Two options for Minima 3.0: free-standing (in 6 heights) or hanging (in 4 heights), with a 33 cm depth. Minima 42 is available only in a free-standing variant (in 5 heights), always with a 33 cm depth.



MINIMA 3.0
H188.5 L336 D33



MINIMA 3.0
H79 L306 D33

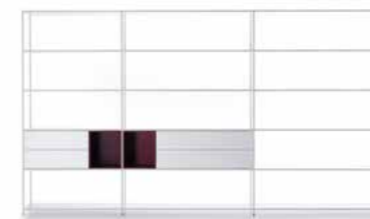

MINIMA 3.0
H188.5 L336 D33



MINIMA 3.0
H188.5 L123 D33

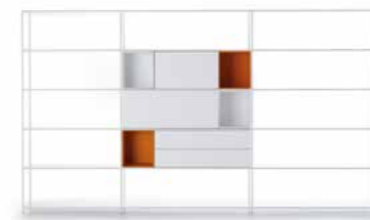

MINIMA 3.0
H188.5 L336 D33

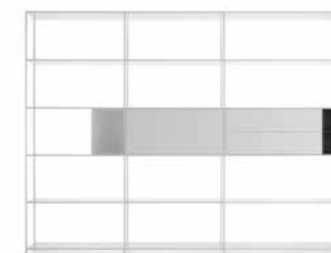

MINIMA 42
H225 L306 D33



COLLECTION

Discover the entire MDF Italia collection, visit our new website www.mdfitalia.it and get inspired by our products.



SYSTEMS



FURNITURE AND BOOKSHELVES

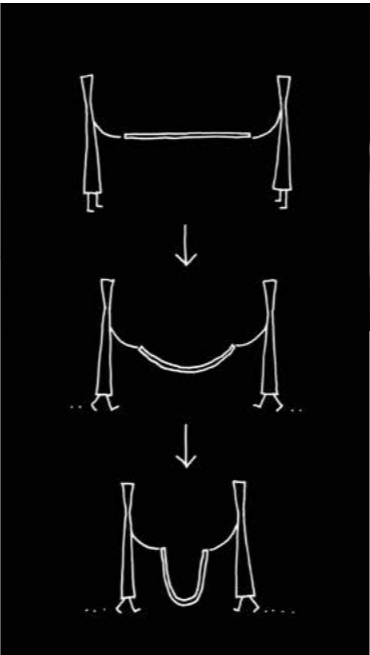

COMPLEMENTS AND BEDS

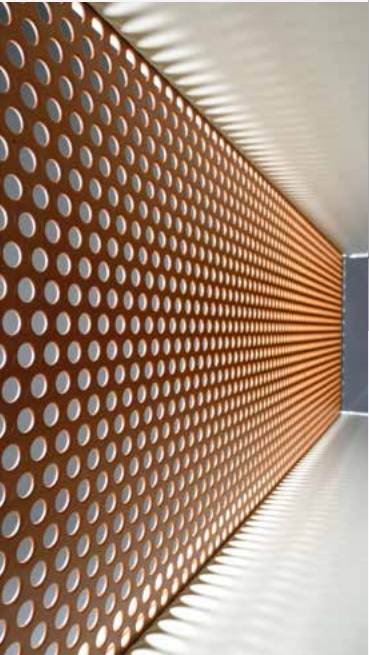

SOFAS AND ARMCHAIRS

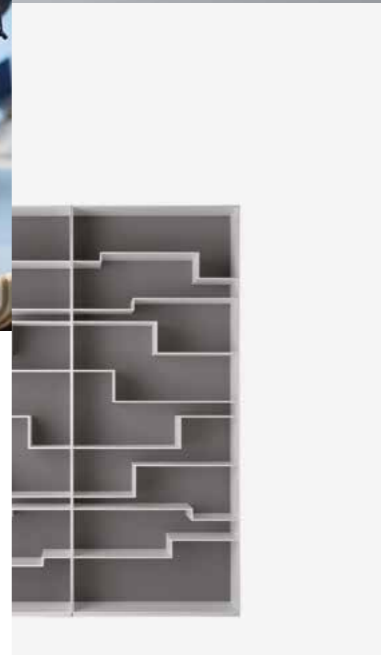

TABLES AND DESKS



CHAIRS AND POUF



COFFEE TABLES



REFERENCES

selection

The significant manufacturing quality can also be found in the furniture designed for hotels, restaurants, banks and offices all over the world. The new contract division, clearly shows that MDF Italia, as always, is willing and ready to face new challenges. Projects ranging from executive offices to creative spaces, from small meeting rooms to large facilities for top management, from minimalistic lounges to spacious waiting rooms. Currently MDF Italia is present in over 50 countries and in the most important cities in the world.



In the next pages you can find a selection of some of our worldwide projects. To discover more, download the Reference Book.

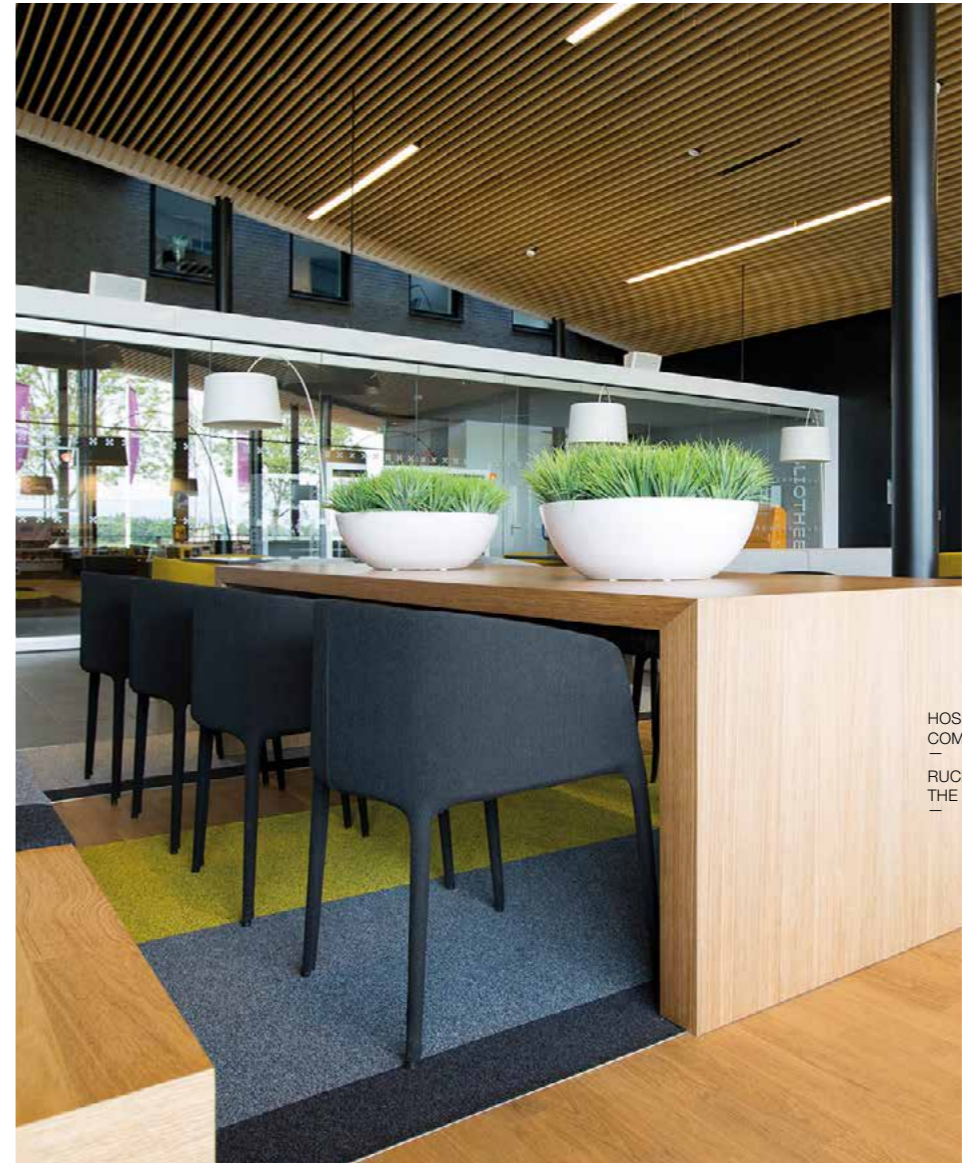
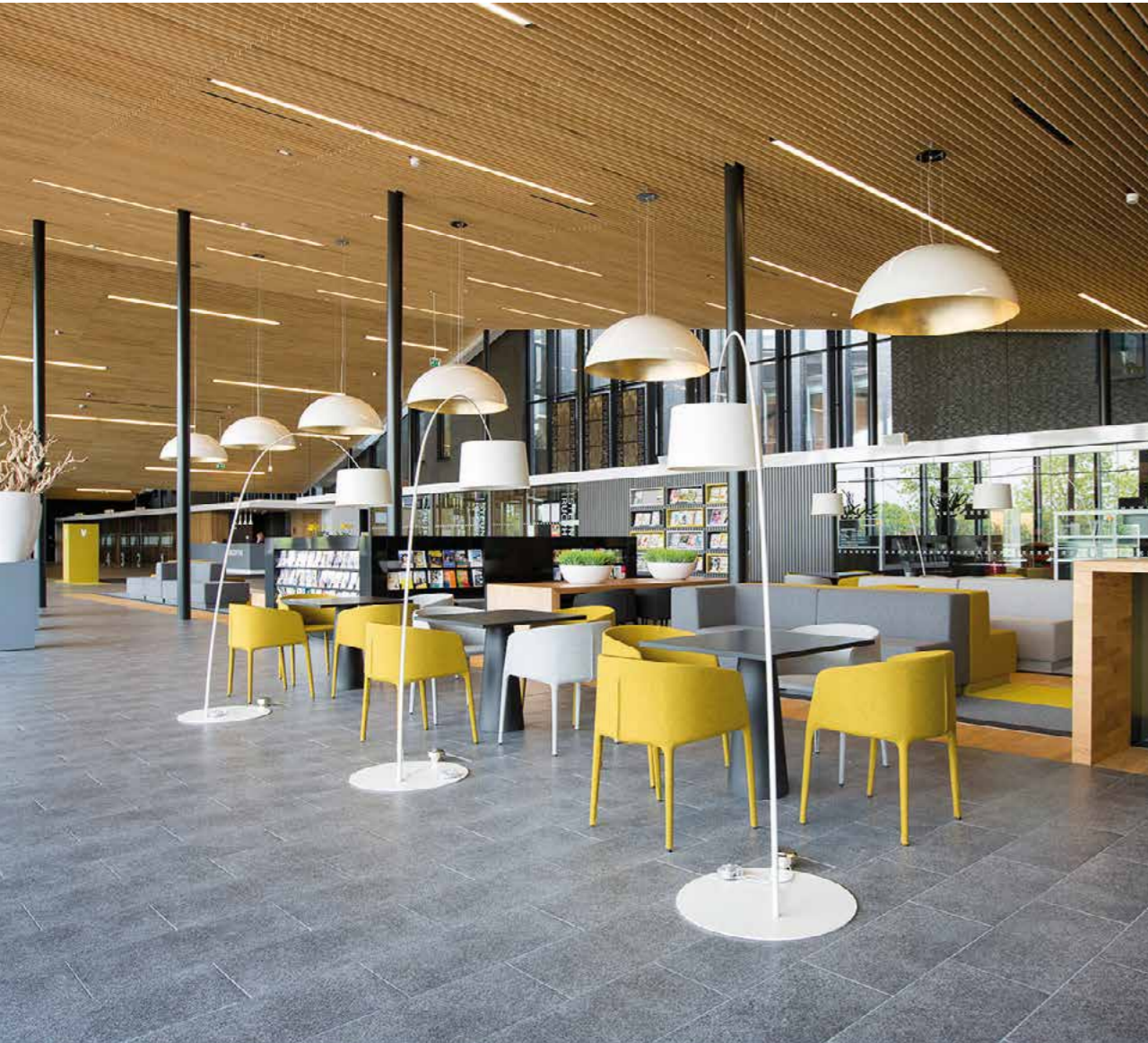

HOSPITALITY, WAITING
COMMUNITY RUCPHEN
—
RUCPHEN
THE NETHERLANDS
—



HOSPITALITY
SPRINGVALE CEMETARY
—
MELBOURNE
AUSTRALIA
—

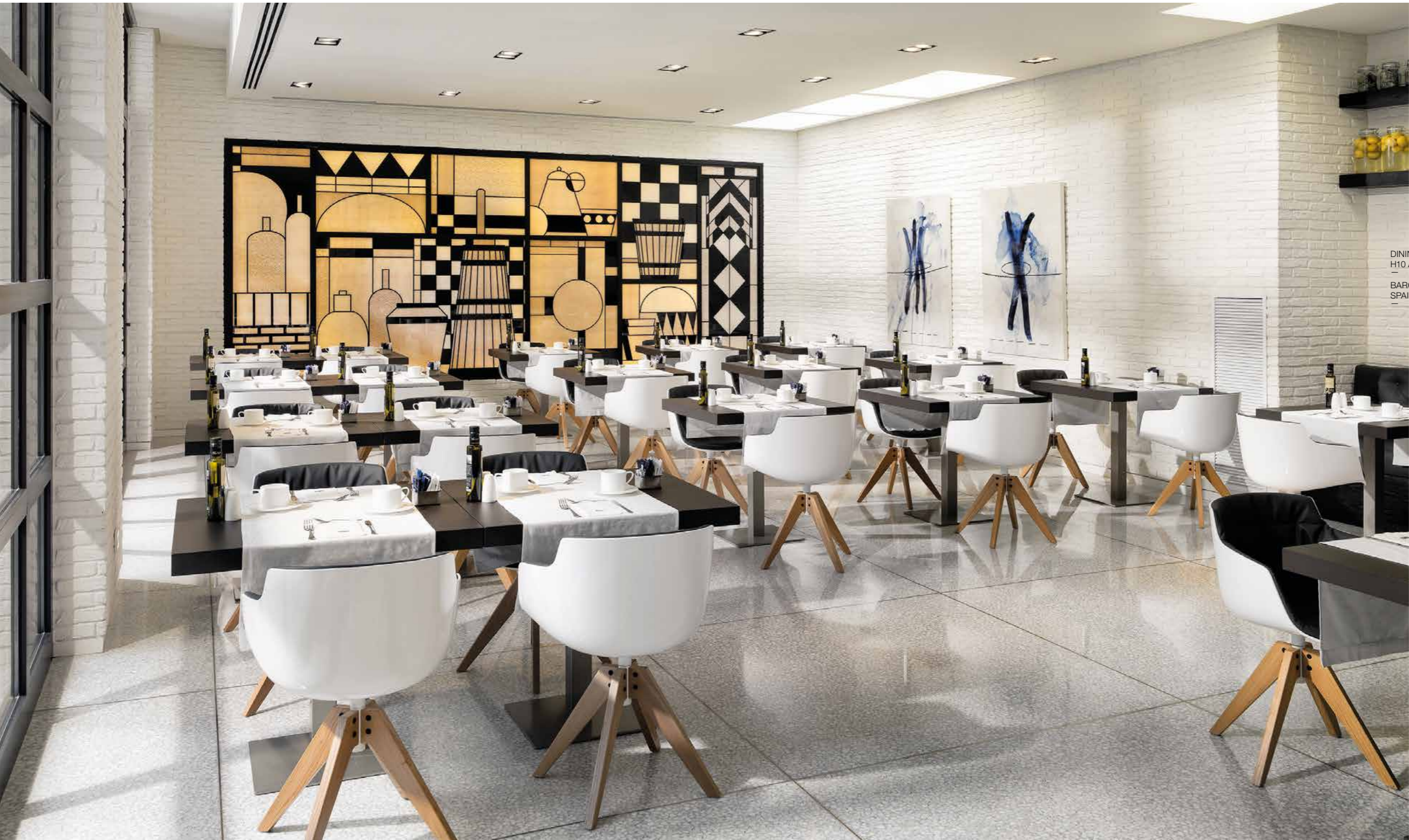

DINING
H10 ART GALLERY HOTEL
BARCELONA
SPAIN

DINING, WAITING
HANEDA INTERNATIONAL
AIRPORT
—
TOKYO
JAPAN
—

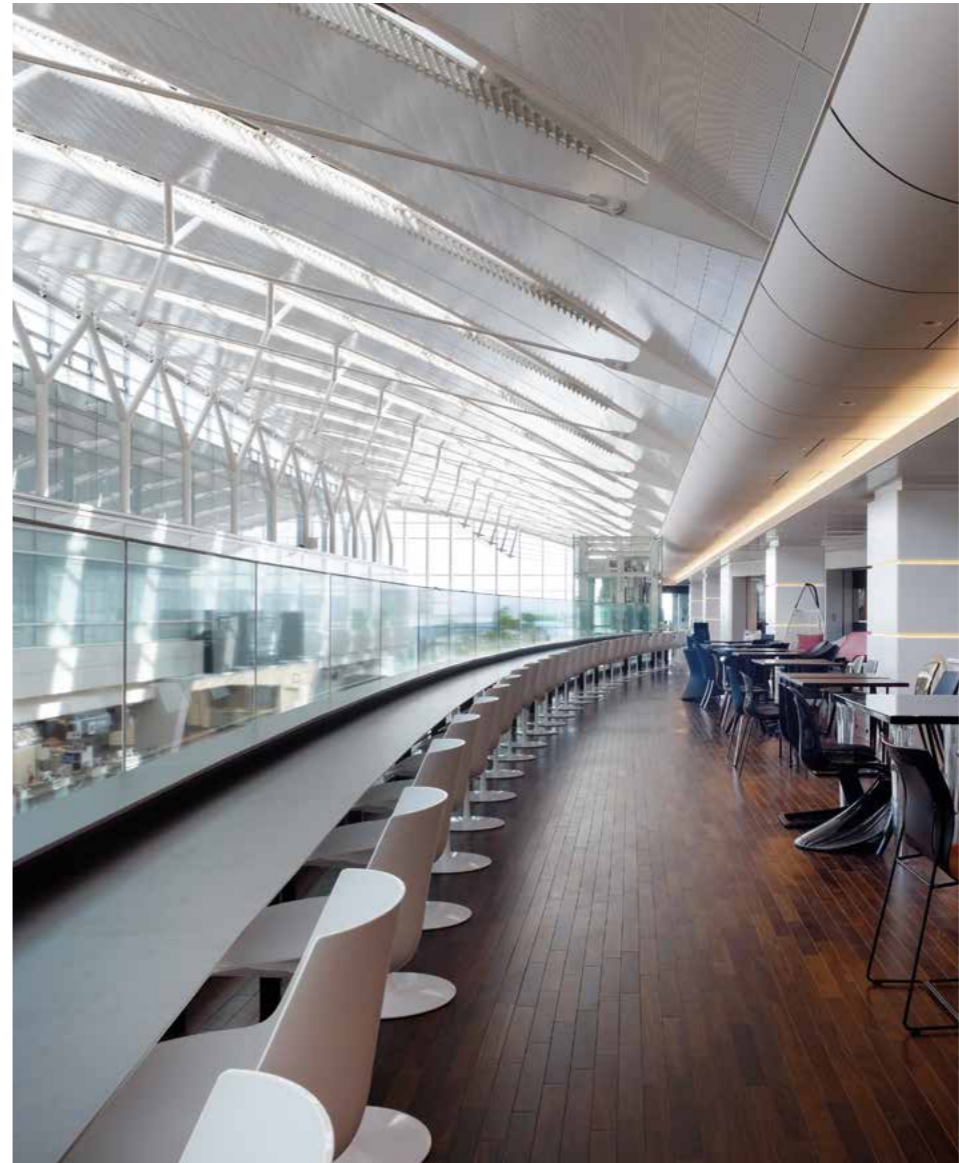

HOSPITALITY
TOWNHOUSE DUOMO HOTEL
SUITE JDF
—
MILAN
ITALY
—



0048
0049

INSTANT BOOK

REFERENCES

RESIDENTIAL
PRIVATE HOUSE
—
ISRAEL
—



WORKING
ASCENDIS PHARMA
—
COPENHAGEN
DENMARK
—





WORKING
SLATTERY AUCTION
—
AUSTRALIA
—



RETAIL
COOK & BOOK
—
BRUXELLES
BELGIUM
—

DINING
SAFFRON RESTAURANT
—
AREZZO
ITALY
—





WORKING
STUDIO ASSOCIATO
—
MILAN
ITALY
—



HOSPITALITY
KURAMATHI ISLAND RESORT
—
MALDIVES
—

0060
0061

INSTANT BOOK

REFERENCES



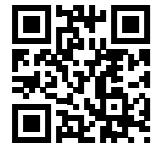

www.mditalia.it

Keep you up-to-date: subscribe to our newsletter and to the reserved area, you can download details on products, 2D and 3D drawings in usable CAD format and high-definition images of the collection.

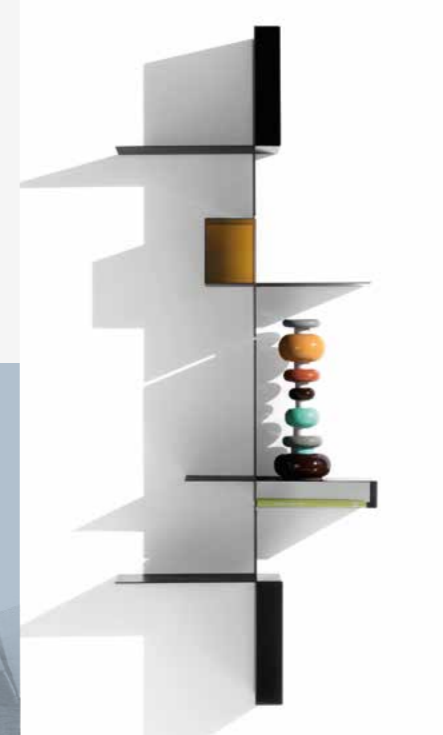
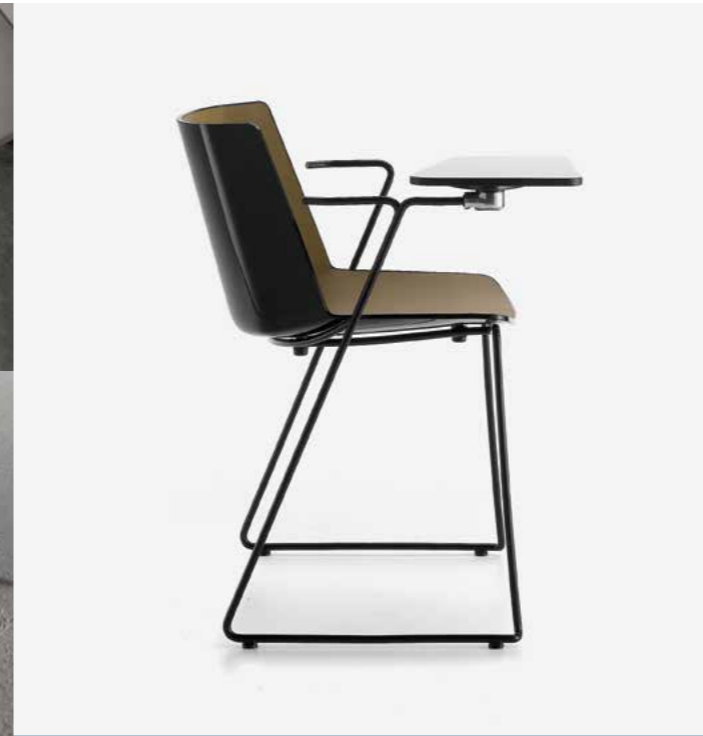
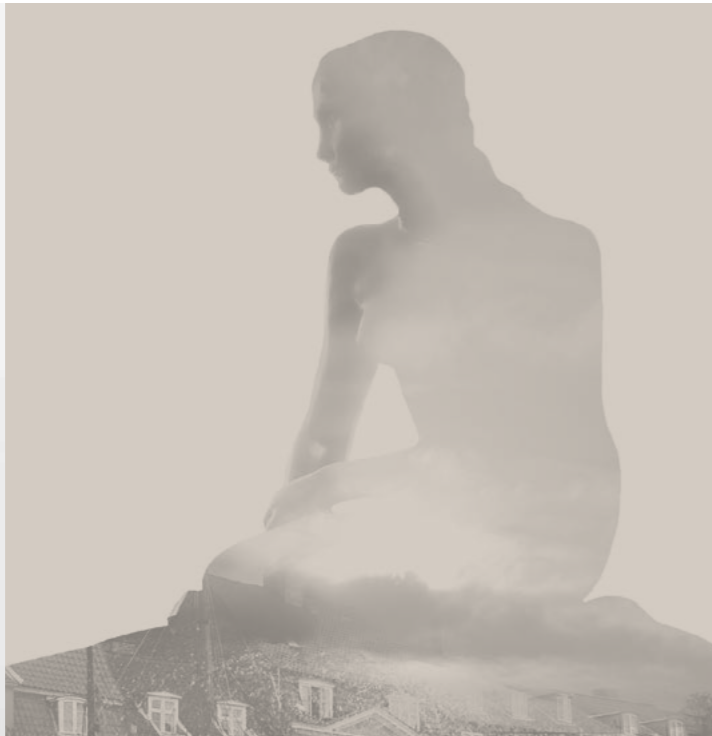

[DOWNLOAD](#)
CATALOGUES / CAD 2D-3D / IMAGES / TECHNICAL INFO

SUBSCRIBE TO THE
RESERVED AREA



FOLLOW US ON  
#mditalia
#milanodesignfurniture

CONCEPT AND GRAPHIC LAYOUT
Marketing MDF Italia

—

IDENTITY
photo —
Andrea Martiradonna

technical photography —
Virtual Desing, Massimo Giovannini

—

COLLECTION
photo —
Studio Controluce

—

MADE AND PRINTED
in Italy
A.G. Bellavite srl
October 2016

www.mdffitalia.it —

for technical specs of the products
we invite you to visit our website.

© Copyright 2016
MDF Italia spa Società Unipersonale
all rights reserved

MDF Italia reserves the right to change,
at any time and without prior warning,
the technical specifications of any
products illustrated in this catalogue.

FOLLOW US ON



MDF ITALIA spa
Società Unipersonale

HEADQUARTER
Via Fratelli Cervi 4/A
22066 Mariano Comense (CO)
0039 031 7570301

SHOWROOM MILANO
via della chiusa
0039 02 58 317168

contract@mdffitalia.it
www.mdffitalia.it

REFERENCES

Community Rucphen
sales partner Aarts & co kantoor
en projectinrichters
photographer Tommy de Lange

Springvale Cemetary
sales partner Hub Furniture
photographer Shannon Mcgrath

H10 Art Gallery Hotel
interior architect Pedro Peña
sales partner Pedro Peña

Haneda International Airport
Terminal 2 - Food Court
interior architect Hiroshi Nakamura
& Nap Architects
sales partner Knoll Japan Inc.
photographer Daici Ano

Townhouse Duomo Hotel Suite JDF
interior architect D2U - Jacopo Della Fontana
sales partner Showroom MDF Italia

Private House
interior architect Pitsou Kedem architects
sales partner Habitat
photographer Amit Geron

Ascendis Pharma
interior architect Kåre Haslund
sales partner Interstudio Denmark
photographer Morten Meldgaard

Slattery Auction
interior architect Elenberg Fraser
sales partner HUB Furniture
photographer Peter Clarke Photography

Cook & Book
interior architect DF Delacroix et Friant,
Antiques & Design
sales partner Instore
photographer BY2 Photographers

Saffron Restaurant
interior architect Studio Svetti Architecture
sales partner Salci Arreda Arezzo
photographer Andrea Bartolozzi - Pickselmedia

Kuramathi Island Resort
sales partner Evo Home

Studio Associato
interior architect and photographer
Giorgio Totino, Twister Architetti Associati
sales partner Showroom MDF Italia