

Minima 3.0 ground-resting

Designer	Bruno Fattorini, Robin Rizzini
Year	2013-2023



Minima 3.0 is a modular and versatile shelving system designed to meet every aesthetic and functional requirement. Made from aluminium, this furniture system stands out for its essential design and remarkable adaptability, making it an ideal choice for offices, contemporary open spaces, executive offices, and hospitality environments.

Recognised as a contemporary icon within MDF Italia's collection, Minima 3.0 combines an essential structure with exceptional modular flexibility. Its wide range of customisable elements, including open units, drawers, and storage units, allows for tailored solutions to meet specific functional and practical requirements.

The versatility of Minima 3.0 is reflected in its various configurations, including ground-resting and hanging options, as well as versions like Sideboard, and Room Divider. Elegant finishes and the integration of LED lighting into the shelves complete a furniture system capable of enhancing any interior design project.

Uprights and shelves

Frames and shelves made of extruded aluminium matt painted and assembled using a concealed joining system. Aluminium frame with a 1.5x1.5 cm section and shelf thickness of 1.5 cm. End frames are equipped with an extruded aluminium pressure cap.

Cabinets Basic. Open

L30 D33 H35 cm

8 mm thick medium-density wood fibreboard, with a matt lacquered or wood veneer finish.

Cabinets Basic. Rop-leaf door/Drawers

L60/L90 D33 H35 cm

Medium-density wood fibreboard with variable thickness, available in a matt lacquered or wood veneer finish.

- Flap door: door equipped with downward compass opening, with retractable mechanism with a stainless-steel cable, shock-absorbing system, adjustable in intensity and strength in the closing and opening phases.
- Drawers: double drawer equipped with push-pull opening system, with totally-extractable guides.

Notes for the cabinets

- Freely resting on the structure.
- Upon request, lock for cabinets (excluding Extra cabinets) available with a universal key or with a cipher key.

Notes for the ground-resting version

- Available in eight heights: 42.5 / 79 / 115.5 / 152 / 188.5 / 225 / 261.5 / 298 cm.
- Shelf available in the nominal lengths (internal light) 30, 60, 90 and 120 cm.
- The first shelf is placed at 4.2 cm from the ground, and the frames are equipped with adjustable feet in aluminium with a 0/+1.5 cm adjustment. The inner height of the compartments is always 35 cm. Depth 33 cm.
- The Ground-resting version can be equipped with lighting. The system includes a low voltage electrified frame with integrated copper track; shelves L60/90/120 with recessed LED bar flush with outer surface. Light intensity can be adjusted with the remote control provided.

Cabinets Extra. Rop-leaf door/Drawers

L60/90/120 D33 H35 cm

Made from melamine-faced fibreboard panels in grey (similar to RAL 7012). The interior of the unit is always grey, while the outside of the back panel is available in a lacquered finish to match the shelving structure.

- Cabinets with flap opening door: door with an innovative pantograph opening and closing mechanism, completely concealed inside the side panels, for extreme ease of opening. The door consists of a matt powder-coated aluminium frame. The rear of the door is a 4 mm thick wood fibreboard panel laminated in grey (similar to RAL 7012). Available in a back-painted glass finish or grooved Cimento® panel, matching the colour of the storage unit structure.
- Drawers: double drawer fitted with push-pull opening system and full-extension concealed slides. The drawer front is a panel faced with grey with an epoxy powder-coated aluminium frame in various colours that houses the relative finishing panels, available in: back-painted glass or grooved Cimento® panel, matching the colour of the storage unit structure.

Notes for the hanging version

- Available in four heights: 38 / 74.5 / 111 / 147.5 cm.
- Shelf available in nominal lengths (overall internal size) of 60, 90 and 120 cm.
- Inner height of compartments is always 35 cm. Depth 33 cm.

Notes for the assembly and feasibility

- For a proper use, we suggest to install the drawers at the bottom of the unit.
- To use this system H152, H188.5, H225 cm (except H261.5 and H298 cm) as a room divider for home and work environments, it is mandatory to join two structures together to obtain a ground depth of 66 cm to ensure a proper stability to the system. The screws for the joining are included in the installation kit.
- The wall fixing is for always suggested for heights 152 / 188.5 / 225 / 261.5 / 298 cm and for compositions with heights 42.5 / 79 / 115.5 cm if equipped with drawer containers. The wall end frames are provided with holes for the wall fixing.
- For centre-stand compositions, with heights of 42.5, 79 and 115.5 cm, equipped with drawer containers, simultaneous opening of all drawers is not recommended, as it could cause the overturn of the structure.
- Upon request, special heights till average 400 cm maximum can be produced.

Minima 3.0 ground-resting finishes

Uprights and shelves

Matt painted white X053
Matt painted graphite grey X054
Matt painted shadow grey X122
Matt painted pearl nickel X123

Cabinets Basic

Rop-leaf door/Drawers

Matt lacquered white X042
Matt lacquered pearl nickel
Matt lacquered shadow grey
Natural black wood X029

Cabinets Extra

Rop-leaf door/Drawers

Lacquered glass white X011
Lacquered glass black X012
Lacquered glass shadow grey X148
Lacquered glass pearl nickel X149
White grooved Cimento X150
Graphite grey grooved Cimento X151
Shadow grey grooved Cimento X152
Pearl nickel grooved Cimento X153

Open

Matt lacquered white X042
Matt lacquered pearl nickel
Matt lacquered shadow grey
Matt lacquered navy blue X165
Matt lacquered burgundy X163
Matt lacquered English green X164
Matt lacquered dune X162
Matt lacquered orange X047
Matt lacquered green X049
Matt lacquered avio blue X050
Matt lacquered mustard yellow X048
Matt lacquered dark red X046
Fine Wood - Italian walnut X119

Minima 3.0 ground-resting dimensions

Minima 3.0 Ground-Resting

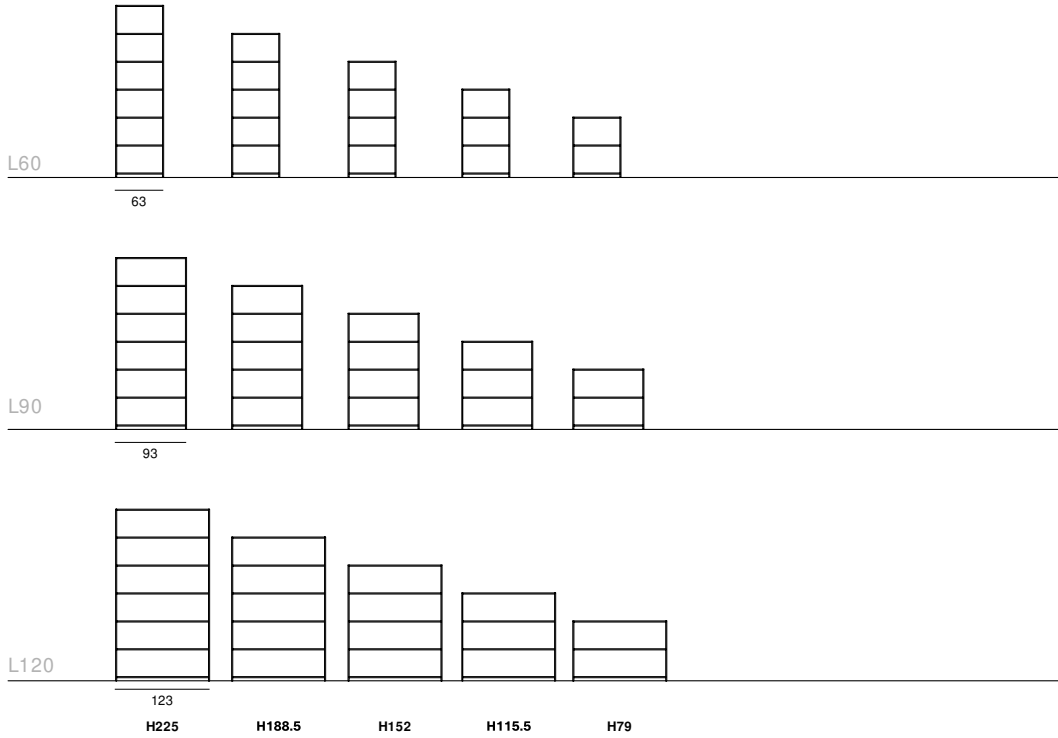

Basic cabinets D33 for Minima 3.0 Ground-resting, Hanging and Room Divider

Open cabinet L30



L30 D33 H35

Cabinets with flap opening door L60/90



L60 D33 H35

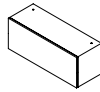

L90 D33 H35

Cabinets with two drawers L60/90

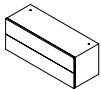

L60 D33 H35

Lock for Basic cabinet, upon request

Flap door



Drawers

For the cabinets with two drawers, the lock can only be put on the top drawer.

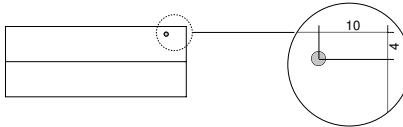

Shelves

The shelving lengths are nominal and correspond to the inner usable space of the bookcase.



60

nominal L60
real L61.5

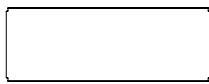

90

nominal L90
real L91.5

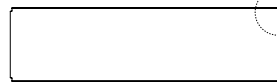

120

nominal L120
real L121.5

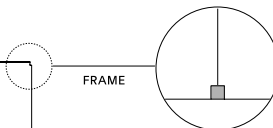

FRAME

Extra Cabinets D33 for Minima 3.0 Ground-resting, Hanging and Room Divider

Cabinets with flap opening door L60/90/120
in grooved Cimento



L60 D33 H35

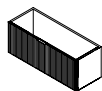

L90 D33 H35

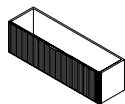

L120 D33 H35

Cabinets with flap opening door L60/90/120
in rear-lacquered glass



L60 D33 H35

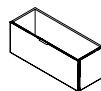

L90 D33 H35

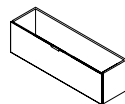

L120 D33 H35

Cabinets with two drawers L60/90/120
in grooved Cimento



L60 D33 H35

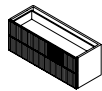

L90 D33 H35

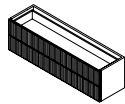

L120 D33 H35

Cabinets with two drawers L60/90/120
in rear-lacquered glass



L60 D33 H35

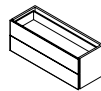

L90 D33 H35

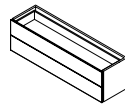

L120 D33 H35